

5-12 AREA

2-5 AREA

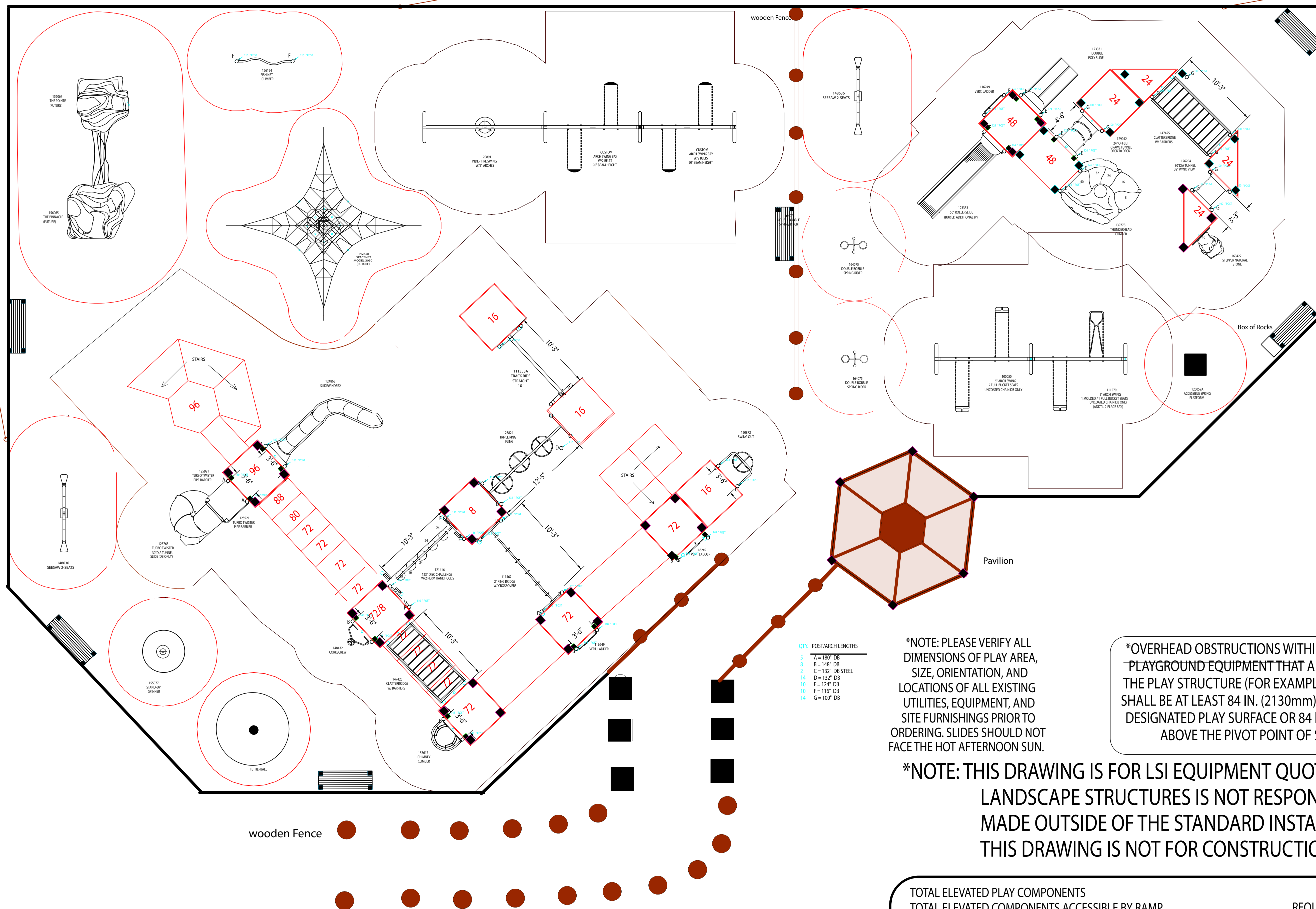

FUTURE EXPANDED HANDICAPPED AREA

*QUOTED EQUIPMENT IS LABELED

TOTAL ELEVATED PLAY COMPONENTS	REQUIRED
TOTAL ELEVATED COMPONENTS ACCESSIBLE BY RAMP	REQUIRED
TOTAL ELEVATED COMPONENTS ACCESSIBLE BY TRANSFER	REQUIRED
TOTAL ACCESSIBLE GROUND LEVEL COMPONENTS SHOWN	REQUIRED
TOTAL DIFFERENT TYPES OF GROUND LEVEL COMPONENTS	REQUIRED



THESE COMPONENTS CONFORM WITH THE



The play components identified on this plan are IPEMA certified. (Unless otherwise noted) The use and layout of these components conform to the requirements of ASTM F1487.

PLEASE NOTE THAT THIS LAYOUT INCLUDES HEALTHBEAT FITNESS EQUIPMENT IN ADDITION TO PLAY EQUIPMENT. HEALTHBEAT FITNESS EQUIPMENT IS DESIGNED FOR AGES 13 AND OLDER AND THEREFORE DOES NOT FALL UNDER THE SCOPE OF ASTM F1487 THE STANDARD CONSUMER SAFETY PERFORMANCE SPECIFICATION FOR PLAYGROUND EQUIPMENT FOR PUBLIC USE. AGE APPROPRIATE SIGNAGE IS RECOMMENDED.

THIS PLAY AREA & EQUIPMENT, OTHER THAN HEALTHBEAT EQUIPMENT, IS DESIGNED FOR AGES 2-12 YEARS UNLESS OTHERWISE NOTED ON PLAN.

IT IS THE MANUFACTURER'S OPINION THAT THIS PLAY AREA DOES CONFORM TO THE A.D.A. ACCESSIBILITY GUIDELINES (ADAAG), ASSUMING AN ACCESSIBLE PROTECTIVE SURFACING IS PROVIDED, AS INDICATED, OR WITHIN THE ENTIRE USE ZONE.

THIS CONCEPTUAL PLAN WAS BASED ON INFORMATION AVAILABLE TO US. PRIOR TO CONSTRUCTION, DETAILED SITE INFORMATION INCLUDING SITE DIMENSIONS, TOPOGRAPHY EXISTING UTILITIES, SOIL CONDITIONS, AND DRAINAGE SOLUTIONS SHOULD BE OBTAINED, EVALUATED, & UTILIZED IN THE FINAL DESIGN. PLEASE VERIFY ALL DIMENSIONS OF PLAY AREA, SIZE, ORIENTATION, AND LOCATION OF ALL EXISTING UTILITIES, EQUIPMENT, AND SITE FURNISHINGS PRIOR TO ORDERING. SLIDES SHOULD NOT FACE THE HOT AFTERNOON SUN.

CHOOSE A PROTECTIVE SURFACING MATERIAL THAT HAS A CRITICAL HEIGHT VALUE OF AT LEAST THE HEIGHT OF THE HIGHEST ACCESSIBLE PART/FALL HEIGHT OF THE ADJACENT EQUIPMENT. (REF. CONSUMER PRODUCT SAFETY COMMISSION (CPSC) GUIDELINES, SECTION 10: SURFACING.)

ACCESSIBLE/PROTECTIVE SURFACING TO LOOSE FILL MATERIALS.

IT IS THE MANUFACTURER'S OPINION AND INTENT THAT THE LAYOUT OF THESE COMPONENTS CONFORM WITH THE U.S. CONSUMER PRODUCT SAFETY COMMISSION'S (CPSC) "HANDBOOK FOR PUBLIC PLAYGROUND SAFETY".

DESIGNED BY:
MJO

COPYRIGHT: 11/18/2010
LANDSCAPE STRUCTURES, INC.
601 7th STREET SOUTH - P.O. BOX 198
DELAND, MINNESOTA 55328
PH: 1-800-328-0035 FAX: 1-763-972-6091

11/9/10	47659-1-1	MJO
Date	Previous Drawing #	Initials

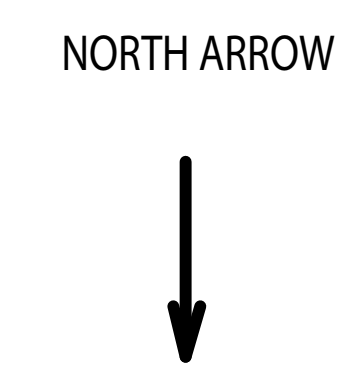
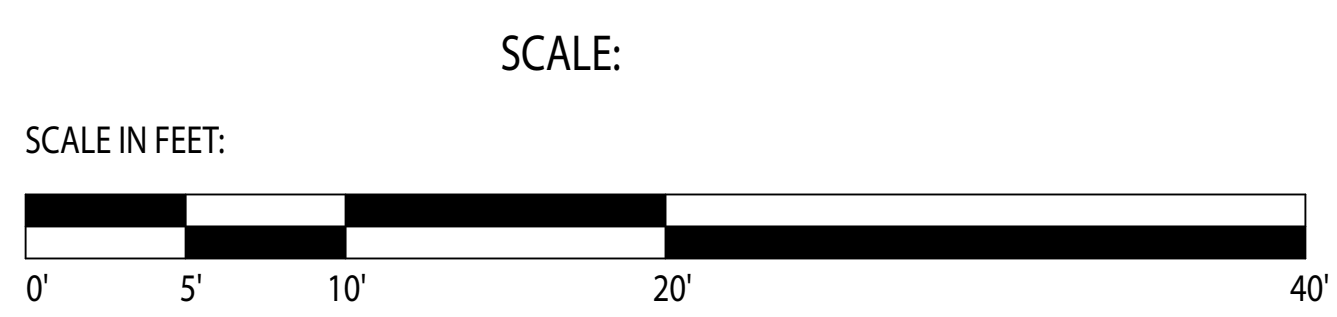

LITTLE NANCY CREEK PARK
ATLANTA, GA.

LANDSCAPE STRUCTURES,
INC.
STEVE HARE

SYSTEM TYPE:
PLAYBOOSTER
DRAWING #:
47659-1-2

